

ELEVATION

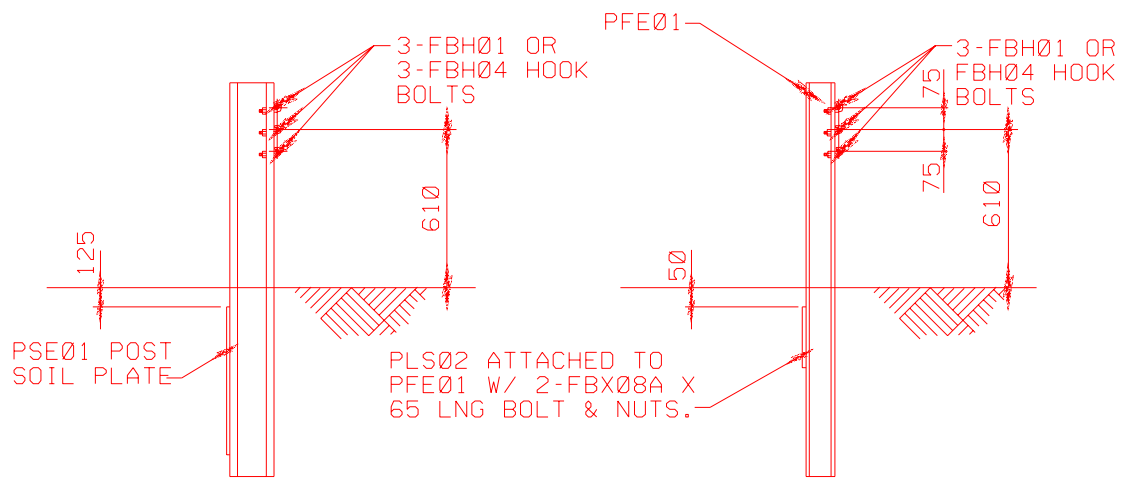

SGR01A

SGR01B

1994

WEAK-STEEL POST CABLE GUARDRAIL

SGR01A - E	
SHEET NO.	REF. NO.
1 OF 2	G1A & G1B

INTENDED USE

Cable guardrails are commonly used where there is adequate room behind the barrier to allow the guardrail to deflect up to 3500 mm. This system must be anchored using a cable anchor and terminal system like SEC01.

COMPONENTS

Unit Length = 5000

	Designator	Component	System	Number
	FBH01	Hook bolts and nuts	a-b	3
or	FBH04	Hook bolts and nuts	a-b	3
or	FBH03	Hook bolts and nuts	a	3
	PFE01	Post	b	1
with	PLS02	Soil plate	b	1
and	FBX08a	Bolt (65 mm) and nut	b	2
	PSE01	Post	a	1
	RCM01	Cable (300 m typical)	a-b	3

REFERENCES

M.D. Graham, W.C. Burnett, J.L. Gibson, R.H. Freer, *New Highway Barriers: The Practical Application of Theoretical Design*, Highway Research Record 174, Highway Research Board, Washington, D.C., 1967, pp. 88-183.

M.E. Bronstad, J.E. Michie and J.D. Mayer, Jr., *Performance of Longitudinal Traffic Barriers*, National Cooperative Highway Research Program Report Number 289, Transportation Research Board, June, 1987.

J.B. Mayer, Jr., *Crash-Test Evaluation of a Franklin Post and Cable Guardrail System*, Southwest Research Institute Test Reports prepared for the South Dakota Department of Transportation, Pierre, S.D., August, 1989.

WEAK-STEEL POST CABLE GUARDRAIL

SGR01a-b

SHEET NO.

DATE

2 of 2

03-22-00

