

**NOTE:**

BOX TUBING IS GENERALLY AVAILABLE IN LENGTHS OF 5490, 7320, AND 10980.

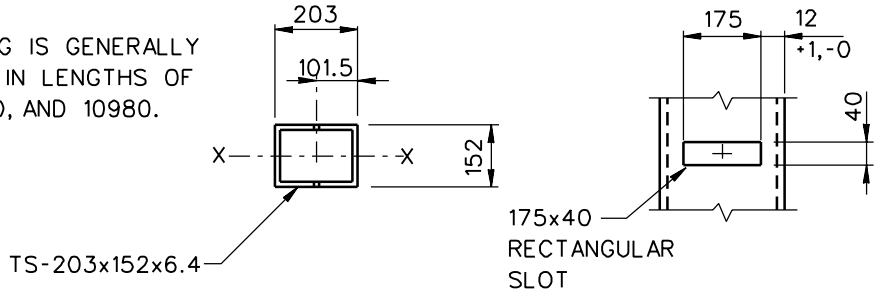

**SLOT DETAIL**

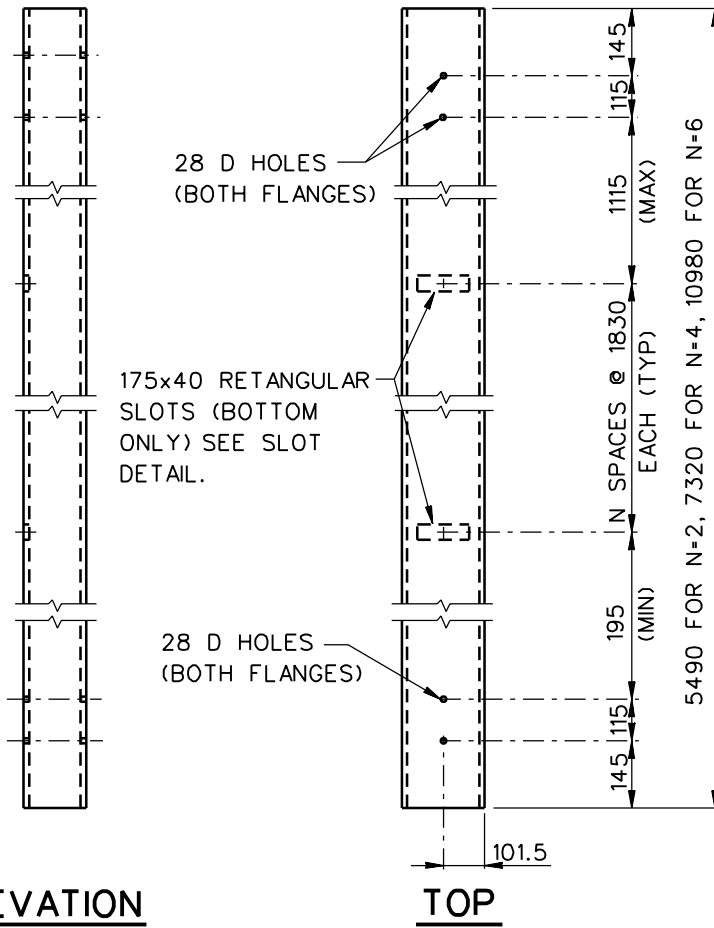

1994

**BOX BEAM MEDIAN BARRIER RAIL**

**RBM11**

SHEET NO.	REF. NO.
1 of 2	RE-12-76